



COLOR 5" TFT-LCD 2 WIRE VIDEO INTERCOM SYSTEM

COMPLETE SYSTEM



Instruction Manual



Model #
VISS7500
www.svat.com

PRODUCT WARRANTY & REGISTRATION

Please visit our website at www.svat.com to apply for your products warranty registration.

The warranty registration for is located under the support tab on the SVAT website.

We take quality very seriously. This is why all of our products come with a one year warranty from the original purchase date against defects in workmanship and materials.

If you have warranty or support issues please contact us using any of the following methods:

SVAT Electronics USA
2315 Whirlpool St., Unit 333
Niagara Falls, New York
USA 14305

SVAT Electronics Canada
4080 Montrose Road
Niagara Falls, ON
Canada L2H 1J9

Phone: 866.946.7828
Fax: 888.771.1701
Email: support@svat.com
Website: www.svat.com

Warranty Terms

1. SVAT products are guaranteed for a period of one year from the date of purchase against defects in workmanship and materials. This warranty is limited to the repair, replacement or refund of the purchase price at SVAT's option.
2. When service is required, the warranty is validated by the submission of a fully completed warranty card.
3. This warranty becomes void if the product shows evidence of having been misused, mishandled or tampered with contrary to the applicable instruction manual.
4. Routine cleaning, normal cosmetic and mechanical wear and tear are not covered under the terms of this warranty.
5. The warranty expressly provided for herein is the sole warranty provided in connection with the product itself and no other warranty, expressed or implied is provided. SVAT assumes no responsibilities for any other claims not specifically mentioned in this warranty.
6. This warranty does not cover the shipping cost, insurance or any other incidental charges.
7. You MUST call SVAT before sending any product back for repair. You will be given a Return Authorization number. When returning the product for warranty service, please pack it carefully in the original box with all supplied accessories, and enclose your original receipt or copy, and a brief explanation of the problem (include RA #).
8. This warranty is valid only in Canada and the U.S.A.
9. This warranty card cannot be re-issued.

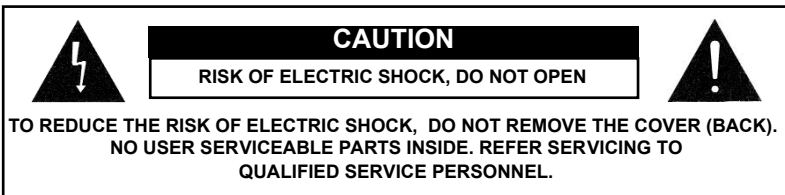

Graphic Symbol Explanation:



The lightning flash with arrowhead symbol, within an equilateral triangle, is intended to alert the user to the presence of uninsulated "dangerous voltage" within the product's enclosure that may be of sufficient magnitude to constitute a risk of electric shock to persons.



The exclamation point within an equilateral triangle is intended to alert the user to the presence of important operating maintenance (servicing) instructions in the literature accompanying the appliance.

WARNING: TO PREVENT FIRE OR SHOCK HAZARDS, DO NOT EXPOSE THIS UNIT TO RAIN OR MOISTURE

TABLE OF CONTENTS

WHAT IS INCLUDED	1
WHAT IS COMPATIBLE	1
IMPORTANT SAFETY PRECAUTIONS.....	2
FEATURES.....	3
PARTS OF THE SYSTEM	3
THINGS TO CONSIDER	4
FUNCTIONS.....	4
WIRING DIAGRAM	5
MULTIPLE MONITOR WIRING DIAGRAM	6
MONITOR INSTALLATION & OPERATION	7
CAMERA INSTALLATION & OPERATION.....	8
SPECIFICATIONS	9

WHAT IS INCLUDED



1 Monitor



1 Camera



60' Extension
Wire



1 RCA Output
Converter



1 Power Adapter



1 Metal Mounting
Bracket

- 2 Window Warning Stickers
- Mounting Hardware
- 1 Year Warranty
- Instruction Manual
- Online/Toll Free Tech Support

WHAT IS COMPATIBLE

The VISS7500 is compatible with TVs, VCRs, DVRs, computers and other SVAT systems including:



VISS7500M



ClearVu DVRs



Any TV or VCR

IMPORTANT SAFETY PRECAUTIONS

PLEASE READ BEFORE INSTALLING

- Keep the camera, monitor and AC/DC adapter cords out of reach of children.
- Do not place the camera, monitor and AC/DC adapter cords in a crib or playpen.
- Do not use the camera near water or damp and wet environments, such as a bathtub, laundry tub, kitchen sink, or wet basements.
- Locate the camera, monitor and AC/DC adapters where there is adequate ventilation. Do not locate the camera in direct sunlight.
- Do not locate the camera, monitor and AC/DC adapters near heat sources such as heat registers, radiators, ovens, furnaces or other appliances with high operating temperatures.
- Do not use with extension cords. Use only the AC/DC adapters provided with this system. ***Note: Use of other adapters may damage the units and void your warranty.
- Only plug components into standard household voltage outlets (110VAC, or 60Hz).
- Do not place cords from the AC/DC adapters, camera or monitor where they can be pinched or stepped on. Protect the cords by keeping them out of the way of children, pets and routine household traffic. Do not place heavy objects on power cords or cover cords with rugs or carpet.
- When cleaning, use a DRY, lint-free cloth. Unplug the camera, monitor and AC/DC adapters before cleaning. NEVER immerse any components in water and do not spray cleaners or solvents on the units. Doing so may damage the units or cause electrical shock.
- Unplug the AC/DC adapters from the wall outlet when the system is not in use for extended periods of more than two days; vacations etc...
- Mishandling, alterations or modifications not approved by the manufacturer will void the warranty.

CAUTION!

- Connect this unit ONLY to other compatible units. Do not connect it to any other type of alarm or auxiliary device. Connecting anything else to this unit may damage it or prevent it from operating properly.
- Do not paint over the camera.

IMPORTANT!

ACCESSORIES- Do not place video monitor or equipment on an unstable cart, stand or table. The video monitor or equipment may fall causing serious injury to a child or adult, and serious damage to the equipment. Wall mounting should follow the manufacturer's instruction, and should use a mounting kit approved by the manufacturer.

VENTILATION

Slots and openings in the monitor and the back or bottom are provided for ventilation and to ensure reliable operation of the video monitor or equipment and to protect it from overheating. These openings must not be blocked or covered. The openings should never be blocked by placing the video monitor on a bed, sofa, rug, or other similar surface. Video monitor should never be placed near or over a radiator or heat register. Video monitor should not be placed in a built-in installation such as a bookcase unless proper ventilation is provided.

FEATURES

- Sleek and ultra thin monitor design
- Two wire connection allows you to use the existing wire from your doorbell for easy installation
- 5" TFT-LCD color screen
- Two way communication
- 16V doorstrike capabilities (doorstrike not included)
- Warning alarm siren
- Monitor can be wall mounted or laid flat

PARTS OF THE SYSTEM

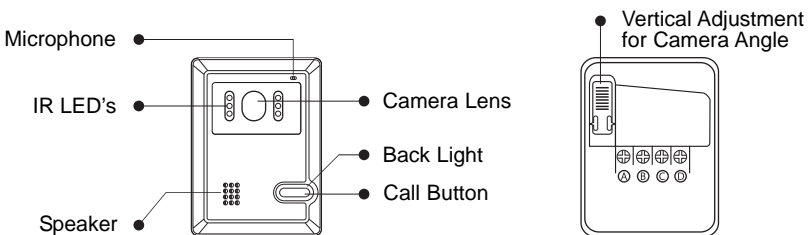
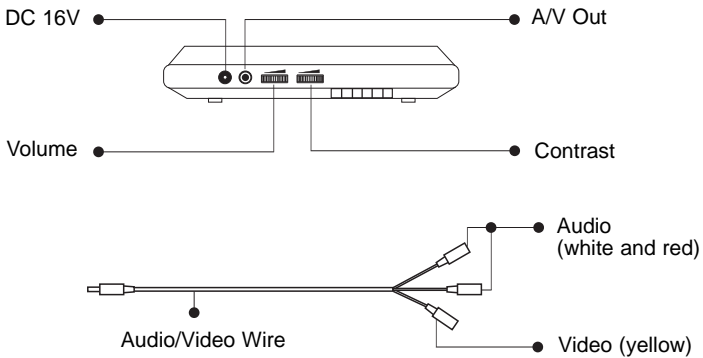
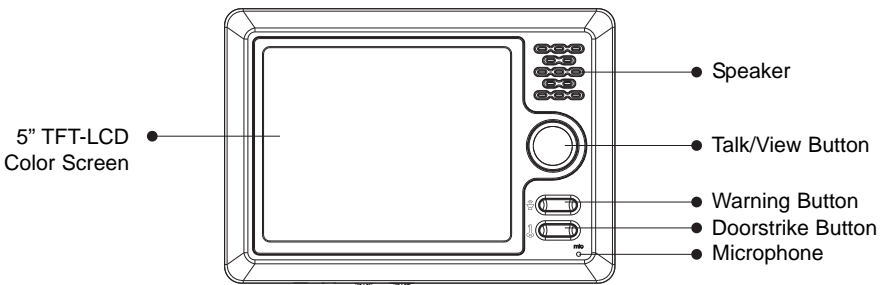

THINGS TO CONSIDER BEFORE INSTALLATION

- Do not place the intercom system near strong magnetic fields, such as televisions and video recorders.
- Turn off the video intercom system power if not in use for extended periods of more than two days; vacations etc...
- Do not place the video intercom system in direct sunlight.
- Do not disassemble this device freely, there are high voltage flows inside the system that can cause bodily harm.

FUNCTIONS

VIDEO INTERCOM

- The device provides audio/video communication between the indoor monitor and the outdoor camera. The picture of the visitor can be seen clearly through the indoor monitor. It is artistically designed and an ideal choice for the modern family.

HIGH RESOLUTION PICTURE

- The high resolution camera and 5" TFT-LCD screen will provide clear vivid images.

NIGHT OPERATION

- The IR LEDs on the camera allow you to view your visitors at night in total darkness.

AUTOMATIC IMAGE DISPLAY

- When the visitor presses the call button, the built-in bell in the monitor will ring and the picture of the visitor will automatically display. To engage in a conversation with the visitor simply press the Talk/View button.

UNLOCK BUTTON

- With a simple press of a button you are able to open the door from the monitor without going to the door directly. (Door strike not included)

SIMPLE INSTALLATION

- The connection between the camera and the monitor is a simple 2 wire connection.

WIRING DIAGRAM



DISCONNECT THE POWER BEFORE CONNECTING/DISCONNECTING THE WIRES. FAILING TO DO SO COULD RESULT IN PERSONAL INJURY OR PERMANENT DAMAGE TO YOUR INTERCOM SYSTEM.

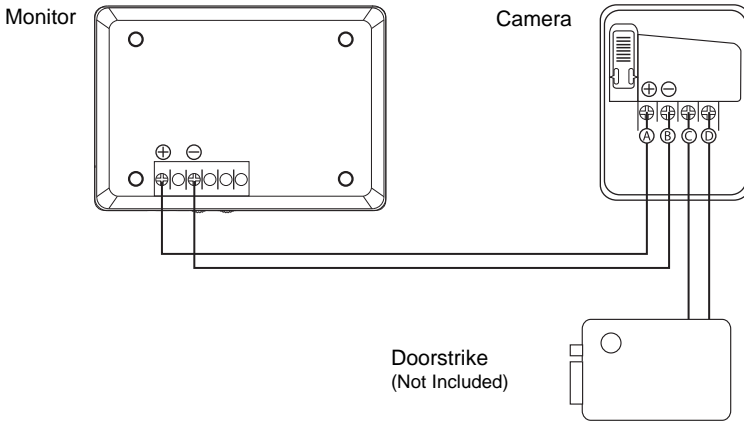

Important Notes

- Wires are color coded and are **NOT** interchangeable.
Make sure the wire that is connected to Pin 1 on the monitor is connected to Pin A on the camera.
Also make sure the wire connected to Pin 3 on the monitor is connected to Pin B on the camera.
- Pins C and D on the camera are for use with the doorstrike. (Doorstrike not included)

WIRING INSTRUCTIONS FOR CAMERA AND MONITOR CONNECTION

1. Run wire to the desired locations for both monitor and camera units making sure that the larger fork connectors are at the camera end and the smaller fork connectors are at the monitor end.
2. On the monitor, loosen the two screws labeled 1 and 3 with a Philips head screwdriver.
3. Take the smaller forked connectors and place them under the loosened screws and tighten securely with the Philips head screw driver.
4. On the camera, loosen the two screws labeled A and B with a Philips head screw driver.
5. Take the larger forked connectors and place them under the loosened screws and tighten securely with a Philips head screw driver.
6. Wiring is now complete.

Wiring diagram found on next page!

MONITOR INSTALLATION & OPERATION

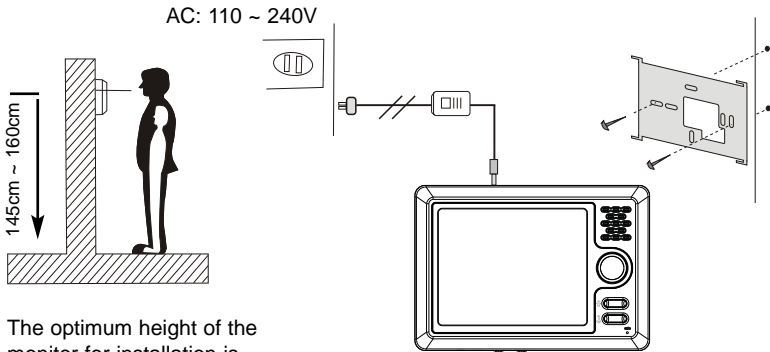

The optimum height of the monitor for installation is 145cm ~160cm from the center of the pick-up tube of the monitor to the ground.

Take two screws and fix the support of the wall-mount on the wall and then install the monitor.

USING THE MONITOR

- When the monitor is in standby, pressing the Talk/View button once turns the monitor and outside camera ON. Monitor and camera will automatically turn off after 1 minute.
NOTE The camera's CALL button must be pressed first by the visitor, followed by the Talk/View button in order to speak with your visitor.
 Do not hold down the talk/view button

DETERRING UNWANTED VISITORS

- If you discover unwanted visitors, pressing the WARNING button on the monitor will engage a loud siren in the outside camera in order to deter the visitor.

ADJUSTING PICTURE/VOLUME

- Volume and Brightness knobs are located at the bottom of the monitor for fine tuning.

DOORSTRIKE

- This system supports any door strike rated at 12V DC. The door will remain unlocked for 10 seconds. Please refer to the wiring diagram for installation. (Doorstrike not included)

CAMERA INSTALLATION & OPERATION

POSITIONING

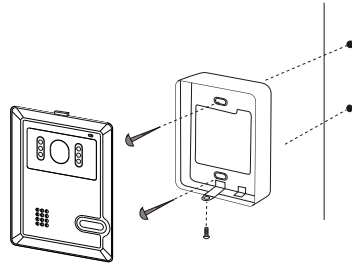
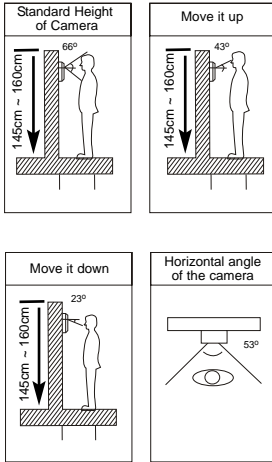

LOCATION

Keep the camera away from direct sunlight or any other bright light sources.

***NOTE:** If your door camera is mounted where existing doorbell wiring exists and is lower than eye level, you can tilt the camera up or down using the knob located on the back of the door camera to adjust viewing height.

USING THE CAMERA

- Press the CALL button on the camera
- Picture of the visitor is displayed on the indoor monitor
- In order to communicate with the visitor press the TALK/VIEW button ONCE and release to begin a two-way communication with the visitor. You do not need to hold down the talk button to speak. When the conversation has ended, press the talk button again to disable two-way communication.
- By pressing the UNLOCK button, you can also open the door for your visitor. (this feature requires an installed door strike, not included)

NOTE The camera's CALL button must be pressed first by the visitor, followed by the Talk/View button in order to speak with your visitor. Do not hold down the talk/view button.

CONNECTING TO A TV

You can connect the monitor to your television/DVR/VCR for viewing and recording purposes. You will need to purchase a separate composite RCA cable (red, white and yellow). Follow these instructions:

1. Plug the included RCA adapter into the monitor
2. Plug the RCA cable into the jacks on the end of the RCA adapter.
3. Plug the RCA cable into the inputs of your television/DVR/VCR.
4. Make sure the television is on the INPUT channel.
5. Whenever video is displayed on the system's monitor, it will also be displayed on your TV.

SPECIFICATIONS

SYSTEM

Number of Wires.....	2
Max. Number of Doorstations.....	1
Max. Number of Monitors.....	1
Communication.....	Full Duplex
Image Memory.....	No
Door Chime.....	Ding Dong Sound, 2 times
Door Strike.....	12V for 5 seconds
Maximum Wiring Distance.....	300ft

DOOR STATION

Image Sensor.....	1/3" CMOS Color
Resolution.....	420 TV lines
Viewing Angle.....	92 Degrees
IP Rating.....	IP68
Night Vision.....	Yes
IR LEDs and Range.....	6, up to 10ft
IR LED Control.....	No
Min. Illumination.....	0 lux
TV System.....	NTSC
Microphone.....	Yes, Built-In
Adjustable Camera Tilt.....	Yes, Vertical
Auto Power Off.....	Yes, 2mins After Answer 1min After Calling Without Answer
Sun Shield.....	No
Mounting Type.....	Surface Mount
Anti-tamper/Video Loss Alert.....	No
Security Warning Siren.....	Yes, Manual
Housing Material.....	ABS Plastic
Housing Color.....	Midnight Black
Operating Temperature.....	14°F ~ 122°F
Operating Humidity.....	80%
Power Input.....	powered by monitor, voltage (12V)
Dimensions.....	5" x 3.75" x 1.375"
Weight.....	0.45lbs

MONITOR

Screen Size.....	5 Inch
Screen Type	LCD
Resolution	960 x 234
Speaker	Yes
Input Terminal	Wire Type
A/V Out Terminal.....	Yes, Composite
Video On/Off Button?	Yes
Adjustable Contrast.....	Yes
Adjustable Brightness	Yes
Operating Temperature	5°F ~ 122°F
Operating Humidity	80%
Power Input.....	15V 1.5mA
Power Adapter Input	100~240V - 50/60Hz 0.7A
Dimensions	7.25" x 5.0625" x 1.0625"
Weight.....	1.05lbs

SVAT SUPPORTS CRIME STOPPERS

Crime Stoppers programs are operated as non-profit charities and are managed by a volunteer board of directors who raise funds and pay rewards to individuals who anonymously call with information that helps solve crime.

Rewards are paid for tips that lead to the arrest and indictment of people charged with felony offenses, and to date Crime Stoppers statistics show a conviction rate of approximately 95%.

To receive more information about Crime Stoppers or to make a charitable donation please fill in the fields on the back of this page, cut on the dotted line and mail in.

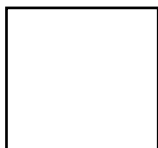

CRIME STOPPERS INTERNATIONAL

P.O. Box 614
Arlington, Texas
U.S.A 76004-0614

SVAT SUPPORTS CRIME STOPPERS

To receive more information about Crime Stoppers or to make a charitable donation please fill in the fields below, cut on the dotted line and mail in.



CRIME STOPPERS INTERNATIONAL

Crime Stoppers International is an organization of community based civilian Crime Stoppers programs, which assist police in solving crime. You can find more information about Crime Stoppers at www.c-s-i.org

Local Crime Stoppers programs are partnerships between the public, media and local policing organizations. Each program is run by a citizen board, whose purpose is to advertise a local telephone number, which anonymous persons can call with information regarding a crime. Callers (lipsters) may be eligible for a cash reward for their information.

If your community does not have a Crime Stoppers program and would like information about starting one, return this card with the following information.

NAME: _____ PHONE: _____

ADDRESS: _____ CITY: _____

PROV/STATE: _____ COUNTRY: _____ POSTAL/ZIP CODE: _____

E-MAIL ADDRESS: _____

Charitable donations can be made to "CSI" by returning this card in an envelope with your check or money order to the address on the other side.

Amount \$ _____

THANK YOU



www.svat.com

Disclaimer

SVAT does not endorse any of SVAT products for any illegal activities. SVAT is not responsible or liable in any way shape or form for any damage, vandalism, theft or any other action that may occur while a SVAT product is in use by the purchaser.



Model #
VISS7500
www.svat.com